

29 149 000 SMARTCONTROL CONCEALED MIXER WITH 3 VALVES

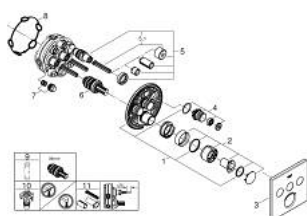

SPARE PARTS, September 2020 – now

- 1: Mounting plate (Spare part-nr. 48362000)
- 2: Handle (Spare part-nr. 46990000)
- 3: Escutcheon (Spare part-nr. 46996000)
- 4: Push button (Spare part-nr. 48361000)
- 5: Cartridge (Spare part-nr. 48359000)
- 5.1: Spindle (Spare part-nr. 49088000)
- 6: Cartridge (Spare part-nr. 46989000)
- 7: Non-return valves (Spare part-nr. 47979000)
- 8: Seal (Spare part-nr. 48360000)
- 9: Socket Spanner (Spare part-nr. 49059000)*
- 10: Service Stops (Spare part-nr. 1405300M)*
- 11: Universal extension set single-lever mixers, 25 mm (Spare part-nr. 14048000)*

* Optional accessories

29 149 000 SMARTCONTROL CONCEALED MIXER WITH 3 VALVES

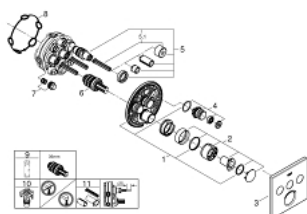

SPARE PARTS, September 2016 – September 2020

- 1: Mounting plate (Spare part-nr. 48363000)
 - 2: Handle (Spare part-nr. 46990000)
 - 3: Escutcheon (Spare part-nr. 46996000)
 - 4: Push button (Spare part-nr. 48361000)
 - 5: Cartridge (Spare part-nr. 48359000)
 - 5.1: Spindle (Spare part-nr. 49088000)
 - 6: Cartridge (Spare part-nr. 46989000)
 - 7: Non-return valves (Spare part-nr. 47979000)
 - 8: Seal (Spare part-nr. 48360000)
 - 9: Socket Spanner (Spare part-nr. 49059000)*
 - 10: Service Stops (Spare part-nr. 1405300M)*
 - 11: Universal extension set single-lever mixers, 25 mm (Spare part-nr. 14048000)*
- * Optional accessories