

27 032 001 RAINSHOWER SYSTEM 210 SHOWER SYSTEM WITH THERMOSTAT FOR WALL MOUNTING

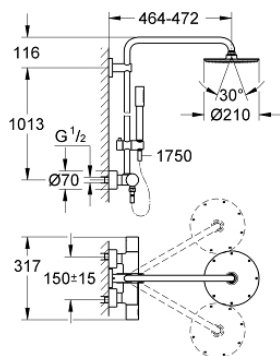

PRODUCT DESCRIPTION

- Colour: chrome
- Consisting of:
 - horizontal swivable 450 mm shower arm
 - exposed thermostat with Aquadimmer function
- Allows change between:
 - Rainshower Cosmopolitan 210 metal head shower
 - With ball joint
 - Rotation angle $\pm 15^\circ$
- metal stick hand shower
- adjustable in height with gliding element
- 69° metal shower hose
- GROHE TurboStat - compact cartridge with wax thermoelement
- GROHE SafeStop - safety button at 38°C
- GROHE SafeStop Plus - optional temperature limiter at 43°C included
- GROHE CoolTouch - no risk of scalding
- GROHE DreamSpray - perfect spray pattern
- GROHE LongLife finish
- GROHE SpeedClean - effortless limescale removal
- Inner WaterGuide - inner insulation for surface protection
- Suitable for instantaneous heaters from 18 kW/h
- minimum flow rate 7 l/min



27 032 001 RAINSHOWER SYSTEM 210 SHOWER SYSTEM WITH THERMOSTAT FOR WALL MOUNTING

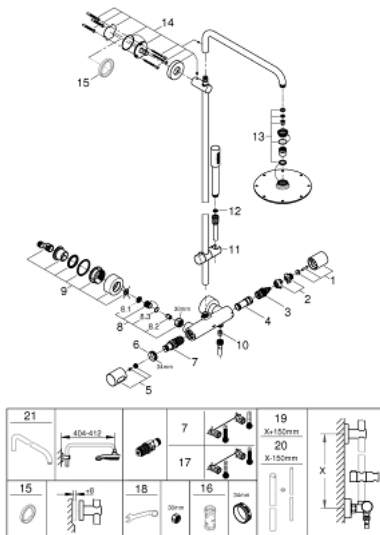

SPARE PARTS, May 2016 – now

- 1: Aquadimmer handle (Spare part-nr. 47804000)
- 2: Stop (Spare part-nr. 47723000)
- 3: Aquadimmer (Spare part-nr. 47364000)
- 4: Water flow (Spare part-nr. 47887000)
- 5: Temperature scale handle (Spare part-nr. 47811000)
- 6: Fitting ring (Spare part-nr. 47743000)
- 7: 1/2" Thermostatic compact cartridge (Spare part-nr. 47439000)
- 8: Non-return valve (Spare part-nr. 47189000)
- 8.1: Dirt Strainer (Spare part-nr. 0726400M)
- 8.2: Non-return valve (Spare part-nr. 08565000)
- 8.3: O-ring (17 x 2mm) (Spare part-nr. 0305500M)
- 9: S-union (Spare part-nr. 12693000)
- 10: Non-return valve (Spare part-nr. 08565000)
- 11: Glide element (Spare part-nr. 12140000)
- 12: Dirt strainer (Spare part-nr. 0700200M)
- 13: Replacement part set (Spare part-nr. 45933000)
- 14: Shower bar holder (Spare part-nr. 48279000)
- 15: Spacer (Spare part-nr. 27180000)*
- 16: Socket Spanner (Spare part-nr. 19332000)*
- 17: GROHE TurboStat cartridge 1/2" (Spare part-nr. 47175000)*
- 18: Special spanner wrench (Spare part-nr. 19377000)*
- 19: Shower system pipe for retrofitting (Spare part-nr. 48053000)*
- 20: Shower system pipe for retrofitting (Spare part-nr. 48054000)*
- 21: Shower arm for shower systems (Spare part-nr. 14047000)*

* Optional accessories