

23 554 001 **START SINGLE-LEVER BASIN MIXER 1/2"** **L-SIZE**

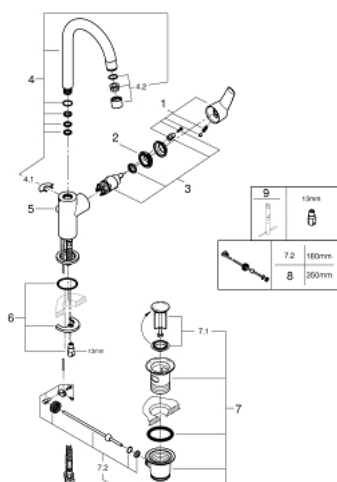

SPARE PARTS, June 2019 – now

- 1: Lever (Spare part-nr. 46900000)
- 2: Fitting ring (Spare part-nr. 46715000)
- 3: Cartridge (Spare part-nr. 46580000)
- 4: Spout (Spare part-nr. 13427000)
- 4.1: Safety ring (Spare part-nr. 4825700M)
- 4.2: Flow control (Spare part-nr. 13935000)
- 5: Pop-up rod (Spare part-nr. 06329000)
- 6: Shank mounting kit (Spare part-nr. 46249000)
- 7: 1 1/4\" waste set (Spare part-nr. 28910000)
- 7.1: Plug (Spare part-nr. 07182000)
- 7.2: Eccentric rod (Spare part-nr. 07052000)
- 8: Eccentric rod (Spare part-nr. 07341000)*
- 9: Mounting wrench (Spare part-nr. 19017000)*

* Optional accessories

23 554 001 **START SINGLE-LEVER BASIN MIXER 1/2"** **L-SIZE**

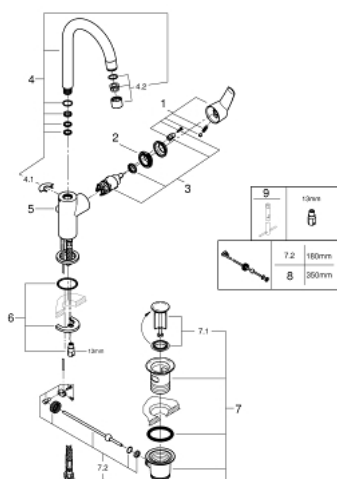

SPARE PARTS, November 2018 – June 2019

- 1: Lever (Spare part-nr. 46900000)
- 2: Fitting ring (Spare part-nr. 46715000)
- 3: Cartridge (Spare part-nr. 46580000)
- 4: Tubular spout (Spare part-nr. 13368000)
- 4.1: Safety ring (Spare part-nr. 4825700M)
- 4.2: Flow control (Spare part-nr. 13967000)
- 5: Pop-up rod (Spare part-nr. 06329000)
- 6: Shank mounting kit (Spare part-nr. 46249000)
- 7: 1 1/4" waste set (Spare part-nr. 28910000)
- 7.1: Plug (Spare part-nr. 07182000)
- 7.2: Eccentric rod (Spare part-nr. 07052000)
- 8: Eccentric rod (Spare part-nr. 07341000)*
- 9: Mounting wrench (Spare part-nr. 19017000)*

* Optional accessories

23 554 001 **START SINGLE-LEVER BASIN MIXER 1/2"** **L-SIZE**

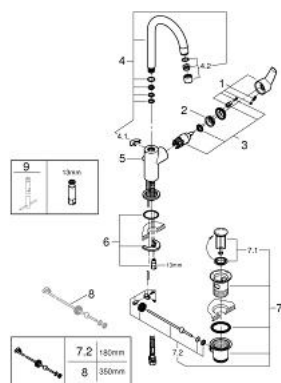

SPARE PARTS, November 2014 – November 2018

- 1: Lever (Spare part-nr. 46900000)
 - 2: Fitting ring (Spare part-nr. 07419000)
 - 3: Cartridge (Spare part-nr. 46580000)
 - 4: Tubular spout (Spare part-nr. 13368000)
 - 4.1: Safety ring (Spare part-nr. 4825700M)
 - 4.2: Flow control (Spare part-nr. 13967000)
 - 5: Pop-up rod (Spare part-nr. 46457000)
 - 6: Shank mounting kit (Spare part-nr. 46249000)
 - 7: 1 1/4" waste set (Spare part-nr. 28910000)
 - 7.1: Plug (Spare part-nr. 07182000)
 - 7.2: Eccentric rod (Spare part-nr. 07052000)
 - 8: Eccentric rod (Spare part-nr. 07341000)*
 - 9: Mounting wrench (Spare part-nr. 19017000)*
- * Optional accessories