

20 421 000 **BAUEDGE PILLAR TAP 1/2"**
XS-SIZE

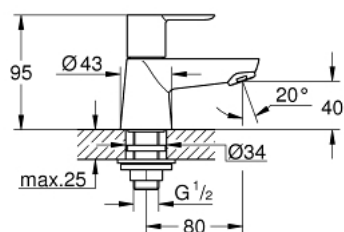

PRODUCT DESCRIPTION

- Colour: chrome
- Single hole installation
- Metal lever
- Ceramic headpart 160;1/2", 90°
- GROHE Long-Life finish
- GROHE Water Saving - Less water, perfect flow
- maximum flow rate (at 3 bar): 5 l/min
- fixation nut G 1/2"



20 421 000 **BAUEDGE PILLAR TAP 1/2"**
XS-SIZE

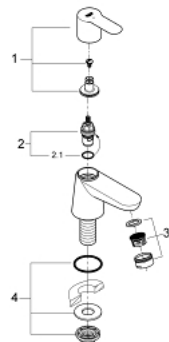

SPARE PARTS, September 2012 – now

1: Lever (Spare part-nr. 48028000)

1.1: Repl. handle connection kit (Spare part-nr. 45186000)

1.1.1: O-ring (18,2 x 1,7mm) (Spare part-nr. 0392400M)

2: Ceramic cartridge (Spare part-nr. 45882000)

2.1: O-ring (18,2 x 1,7mm) (Spare part-nr. 0392400M)

3: Flow control (Spare part-nr. 13952000)

4: Shank mounting kit (Spare part-nr. 45004000)