

19 470 000 **GROHTHERM 3000 COSMOPOLITAN CONCEALED VALVE EXPOSED PART**

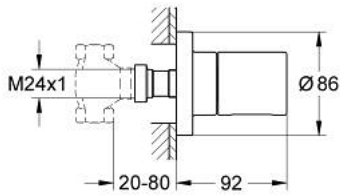

PRODUCT DESCRIPTION

- Colour: chrome
- trim set for 35 028 000
- GROHE LongLife finish
- For GROHE concealed valves, 1/2", 3/4", 1"
- 20-80 mm
- metal escutcheon with wall sealing
- shut-off handle



19 470 000 GROHTHERM 3000 COSMOPOLITAN CONCEALED VALVE EXPOSED PART

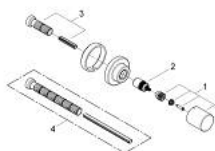

SPARE PARTS, September 2007 – now

- 1: Shut-off handle (Spare part-nr. 47806000)
- 2: Extension for spindle (Spare part-nr. 45204000)
- 3: Extension kit (3 1/8") (Spare part-nr. 45202000)
- 4: Extension-set (7 7/8") (Spare part-nr. 45203000)*

* Optional accessories